

### APPLICATIONS

- Connection of copper or aluminium conductors of Medium Voltage cables

### FEATURES

- Tinned aluminium
- **Range-taking** (multiple sections)
- Suitable for aluminium-to-aluminium, aluminium-to-copper and copper-to-copper connections
- With solid center stop
- Adapter for application on different cross-section cables
- No crimping tool required for installation

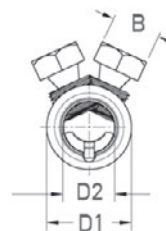
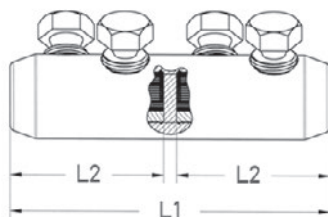

ref.	item	conductor cross-section range (mm <sup>2</sup> )	number bolts of contact	size head bolts B (mm)	conductor material	dimensions (mm)				min./mult. ord. qty (pcs)
						length L1	ext. diam. D1	length int. L2	int. diam. D2	
GR025095	GRMT 25/95	25 – 95	2	14	Cu, Al	65	24	30	12,8	1
GR035150	GRMT 35/150	35 – 150	2	17	Cu, Al	80	28	35	15,8	1
GR095240	GRMT 95/240	95 – 240	4	19	Cu, Al	125	33	60	20	1
GR120300	GRMT 120/300	120 – 300	4	22	Cu, Al	140	37	65	24	1
GR185400	GRMT 185/400	185 – 400	6	22	Cu, Al	170	42	80	25,5	1



### APPLICATIONS

- Connection of copper conductors of Medium Voltage cables

### FEATURES

- Tin-plated copper

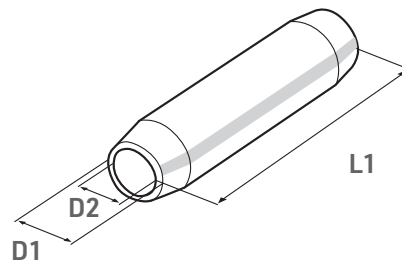

ref.	item	conductor cross-section (mm <sup>2</sup> )	cable conductor material	dimensions (mm)			min./mult. ord. qty (pcs)
				length connector L1	outer diameter D1	internal diameter D2	
GM2535	GMMT 25	25	Cu	60	11	7	1
GM3040	GMMT 35	35	Cu	60	12,5	8,2	1
GM0050	GMMT 50	50	Cu	60	14,5	10	1
GM6370	GMMT 70	70	Cu	70	16,5	11,5	1
GM9510	GMMT 95	95	Cu	80	20	12	1
GM0150	GMMT 120/150	120–150	Cu	80	20	13,5	1
GM0185	GMMT 185	185	Cu	80	23	15	1
GM0240	GMMT 240	240	Cu	100	26,5	19,3	1